



Curtain Road, London, EC2A

BUTLER & STAG



**A fantastic first floor one bedroom, loft style apartment located in the heart of Shoreditch triangle. High ceilings, stripped wood flooring and large factory windows with secondary glazing. Offered with no onward chain**



## Leasehold

- Warehouse Style Apartment
- High Ceilings
- Stripped Wooden Floors
- Shoreditch Triangle
- Ornate Corning
- Secondary Glazing
- Lift Access
- New Lease To Be Assigned





# Curtain Road, EC2A



## First Floor

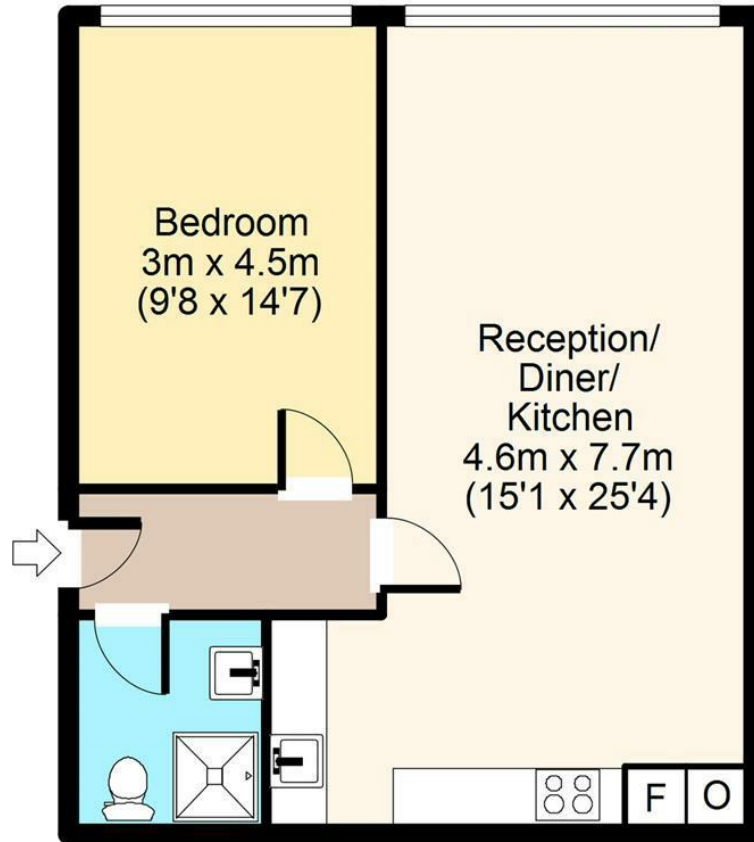

Total area: approx. 50 sq. metres (538 sq. feet)

For illustration purposes only - not to scale

[www.londonpropertyassessments.co.uk](http://www.londonpropertyassessments.co.uk)



# BUTLER & STAG

☎ 020 8102 1236

🏠 508 Roman Road, Bow, London, E3 5LU

✉ [bow@butlerandstag.com](mailto:bow@butlerandstag.com)

[www.butlerandstag.uk](http://www.butlerandstag.uk)

IMPORTANT NOTICE - These particulars have been prepared in good faith and they are not intended to constitute part of an offer or contract. We have not performed a structural survey on this property and the services, appliances and specific fittings have not been tested. All photographs, measurements, floor plans and distances referred to are given as a guide and should not be relied upon.